

# Silent Drawer System

## Modul Box Assembly Instruction

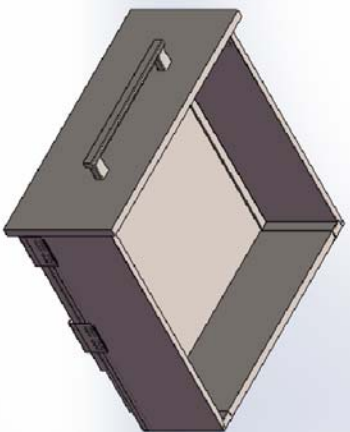

### Special Features:

- Length:270,300,350,400,450,500,550mm.
- The drawer side-board is 203mm high.
- Drawer width can be designed freely with automatic error adjustment.
- Hidden full pulout silencing sliding skid can bear 35kg and enjoys excellent stability and quiet and smooth sliding performance.
- Quick installation and dismantle.
- Newly-designed built-in damper is free from reinstallation and ensures soft and smooth drawer movements.

Basic length	Internally usable drawer depth	Minimum installation depth of drawer	Minimum installation height
270mm	244mm	275mm	225mm
300mm	274mm	305mm	225mm
350mm	324mm	355mm	225mm
400mm	374mm	405mm	225mm
450mm	424mm	455mm	225mm
500mm	474mm	505mm	225mm
550mm	524mm	555mm	225mm

<p><b>1. Guide</b></p> <p>Left/Right</p> <p>Length : 270mm 300mm 350mm 400mm 450mm 500mm 550mm</p>	<p><b>2.Drawer Side &amp; Decorative Cap</b></p> <p>Left/Right</p> <p>Length: 270mm 300mm 350mm 400mm 450mm 500mm 550mm</p>	<p><b>3.Back connector</b></p> <p>Left / Right</p>	<p><b>4.Front connector</b></p> <p>Left / Right</p>
--	---	--	---

### Runner Installation(mm)

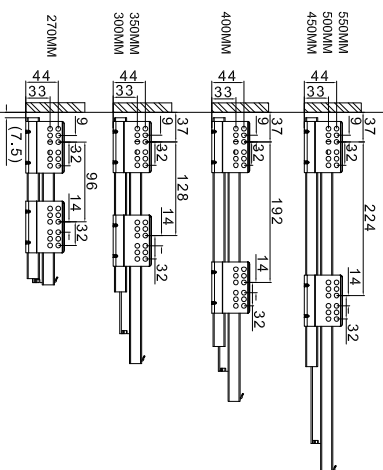

Technology pivot:  
Bottom and Back Panel Measurement  
16MM Density Panel

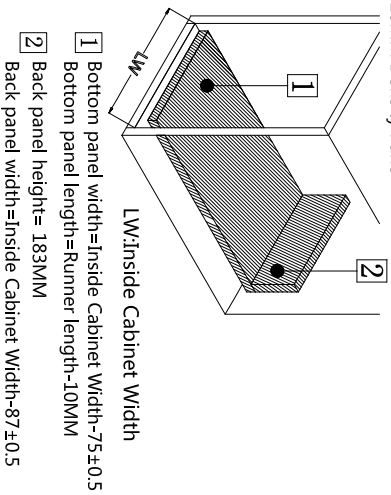

### Inside Cabinet Dimension

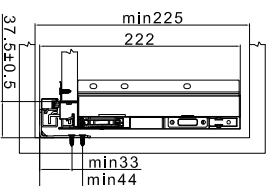

### Front Panel Mounting Positions

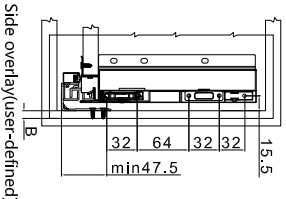

### Front Fixing Brackets Positions

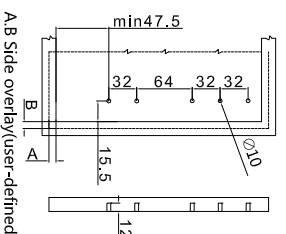

### Back Panel Mounting Positions

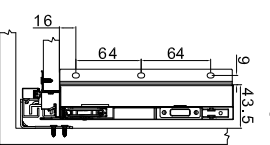

### Front fixing brackets mounting

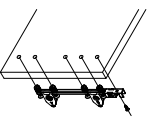

### B Side overlay(user-defined)

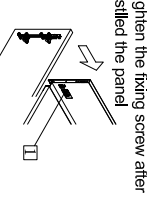

### A B Side overlay(user-defined)

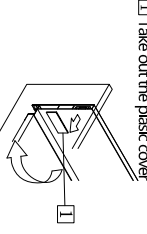

### Back Panel Mounting Positions

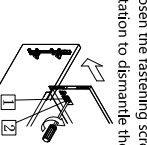

### Front panel height adjustment : ±2mm

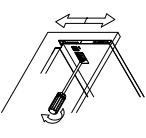

### Front panel side adjustment : right/mm

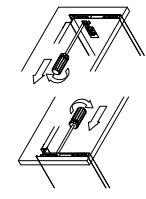

### Front panel side adjustment : left/mm

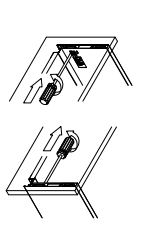

### Mounting the drawer

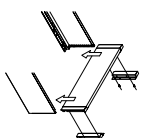

### Function of the damper

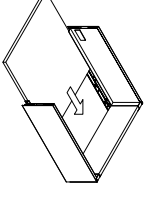

### Installing the drawer

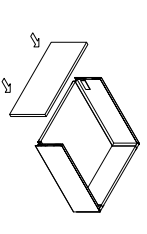

### Removing the drawer

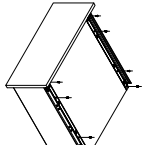

### Function of the damper

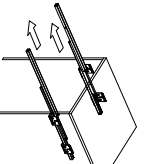

### Installing the drawer

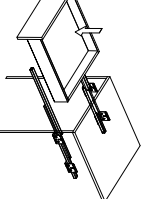

### Removing the drawer

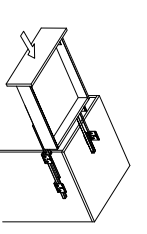

Push the metal spring part from the panel & pull out

### Function of the damper

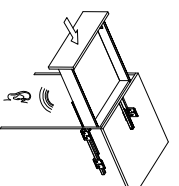

### Installing the drawer

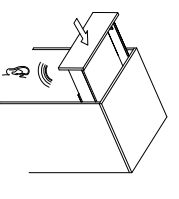

### Removing the drawer

