

# Synchronized Full Extension Undermount Slides With Locking Clips 3D

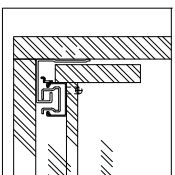

- Load capacity: 35kg
- Finish: zinc plated
- Lengths: 270-550mm
- Synchronized full extension
- Tool free assembly and removal of drawer
- Silent system guarantees smooth run without noise
- Drawer side adjustment:  $\pm 1.5$ mm
- Drawer height adjustment: 0~+3mm
- Drawer depth adjustment: 0~+3mm



## Installation Dimensions (mm)

SKW=Internal Drawer Width      LW=Internal Cabinet Width

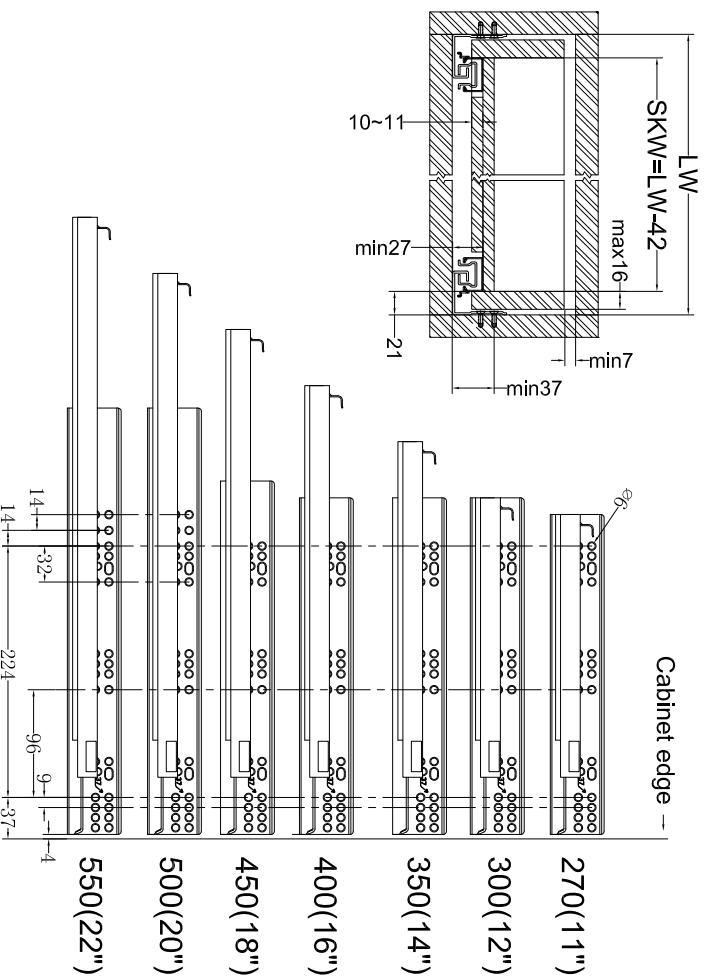

## Installation Dimensions (mm)

NL=Nominal Slide Length  
LT=Internal Cabinet Depth

Standard drawer     $LT_{min}=NL+3$

Internal drawer     $LT_{min}=NL+X+3$

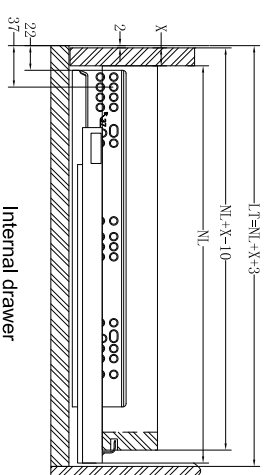
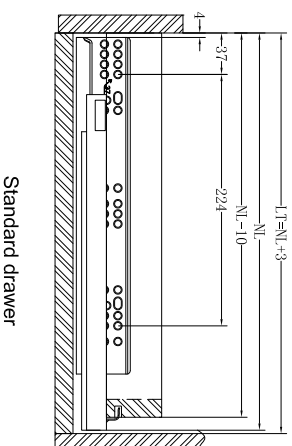

## Drawer size and boring (mm)

- Button 1: Rotary without tools adjustment L&R  $\pm 1.5$
- Button 2: Rotary without tools adjustment highly  $+3^0$
- Button 3: Rotate the handle without tools adjustment to easily remove the drawer!

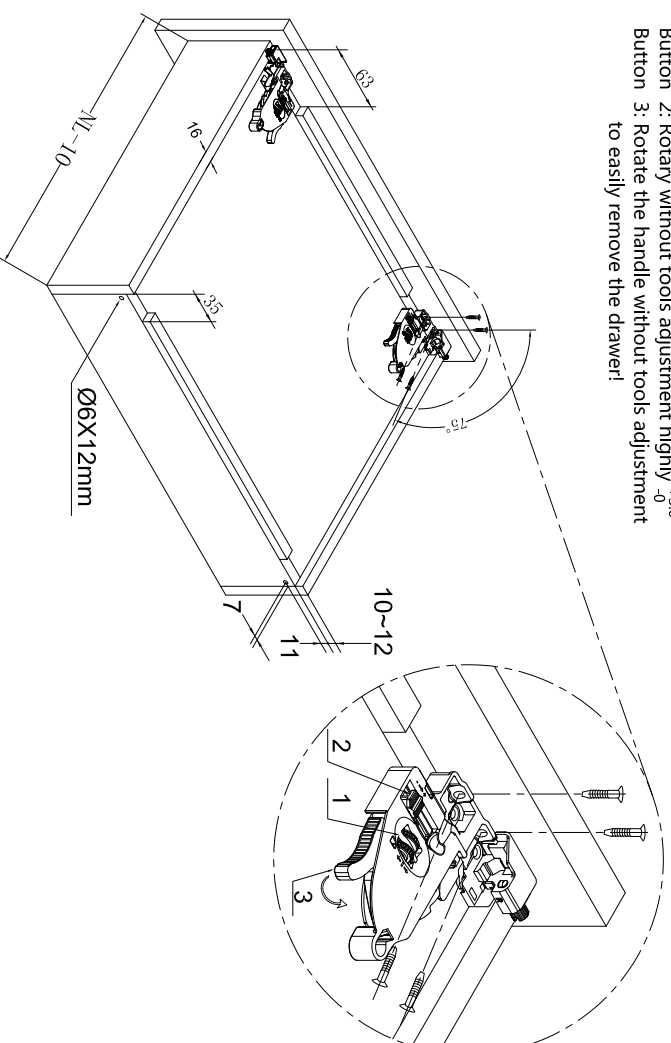

Series	Length	270 (11")	300 (12")	350 (14")	400 (16")	450 (18")	500 (20")	550 (22")
Packing	(Set/Cm)	10	10	10	10	10	10	10

Max drawer side thickness: 16mm